

RZT-60

High-efficiency Package Hydroextractor



RZT-60 high-efficiency package hydroextractor

The RZT-60 model high-efficiency hydroextractor is a semi-automatic centrifugal extractor suitable to eliminate the excess of water from all types of yarn packages after dyeing. It can be successfully used for synthetic, artificial and natural yarns wound on plastic cones / tubes or stainless steel springs.

Special features of the RZT-60 hydroextractor

The high rotation speed (up to 1530 rpm) ensures a very low and uniformly distributed residual moisture content in the yarn packages (e.g. down to approx. 45% on cotton yarns), thus reducing the overall drying cost and improving the final product quality.

Each package is put onto a separate holder to prevent yarn as well as cones / tubes from damages during the hydroextraction cycle. The control system by PLC ensures the fully automatic operation of the machine until the end of each hydroextraction cycle, when the yarn has reached the desired final moisture content. The unique anti-vibration design ensures smooth rotation of the baskets without unbalancing and the overall stable operation of the machine.

Standard configuration

Cast iron basement.

2 suspended-type extracting baskets in stainless steel with individual driving motors and balancing devices.

4 rotating package holders with individual arms.

Hydraulic lifting / lowering system of the package holders equipped with oil pump.

Fully automatic control system by PLC housed inside the stainless steel control box.

STALAM

Dimensions drawing

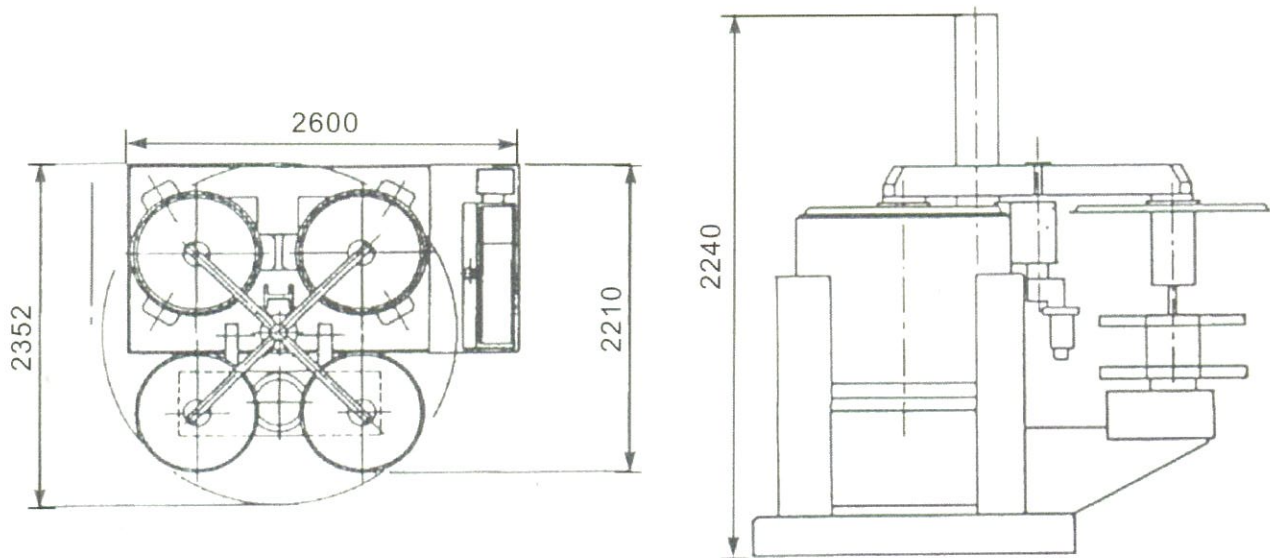

Production data

<i>Yarn type</i>	<i>Extraction Time</i>	<i>Residual moisture</i>
synthetics	3 min.	8-12%
wool blends	4 min.	15-25%
wool / cotton blends	4 min.	25-30%
cotton	5 min.	45-50%
silk	5 min.	35-40%
viscose	6 min.	60-70%

Specifications

Model
Spec.

RZT-60

average capacity

260 ÷ 380 packages/h

installed power

16 kW

rotation speed

1530 rpm

net weight

2500 kg

dimensions

2600 x 2210 x 2240 mm

Note: based on max. package diameter 200 mm