

## Magnetic drive pumps

A worldwide best-seller,  
our high-quality compact magnetic drive pumps

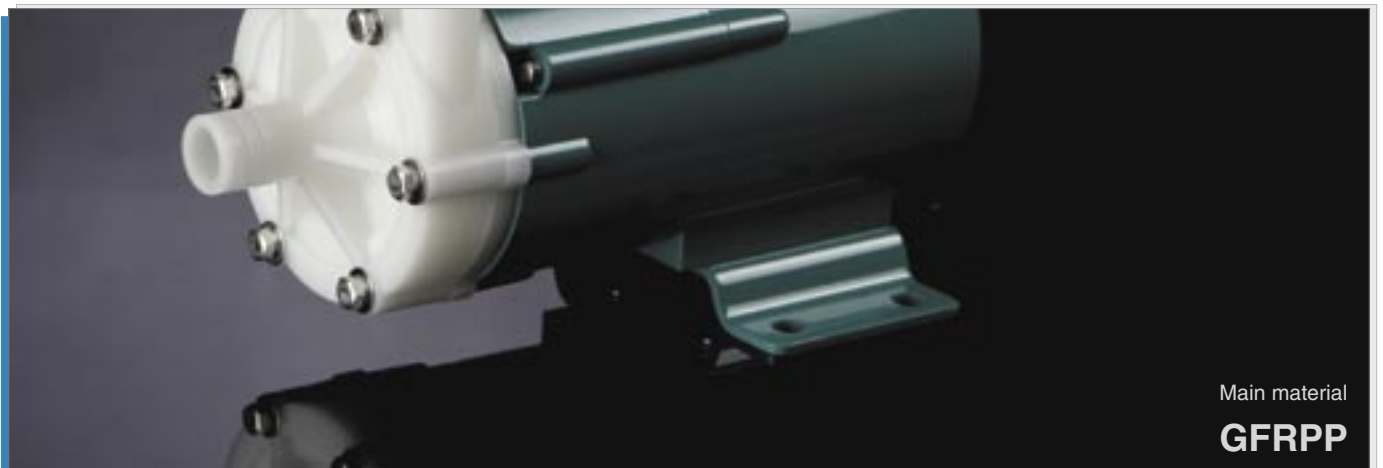

Magnetic drive pumps

Magnetic drive seal-less pumps are free from leakage problems and the need for seal replacement.  
This feature and their compact nature make them ideal for built-in applications.



# A worldwide best-seller, our high-quality compact magnetic drive pumps

Our MD series leak-free compact magnetic pumps are a worldwide best-seller and are used in medical equipment, analyzers, constant-temperature baths and surface treatment equipment for chemical feeding in more than thirty countries worldwide.

## Leak free

Magnetic drive seal-less pumps are free from leakage problems and the need for seal replacement. This feature and their compact nature make them ideal for built-in applications.

## Large selection

The MD series comprises 50 models. The high-head type(MD-Z), the high flow type(MD-X) and threaded connection type(MD-M) are available as well as a standard type. The MD series offers the largest selection in the world.



MD-6



MD-10

### MD-6·10

- Max Discharge capacity **5.5/6.0 - 11/12** l/min
- Max Discharge head **1.0/1.4 - 2.1/2.7** m



MD-15R



MD-20R



MD-30R

### MD-15·20·30·40

- Max Discharge capacity **10/11 - 75/85** l/min
- Max Discharge head **1.8/2.5 - 11.5/13.5** m



The centrifugal pump is driven by a pair of magnets which are incorporated in the impeller and motor shaft. The sealless pump structure eliminates shaft seals such as conventional mechanical seals because the pump chamber is shielded by the casings and the impeller is operated by the magnets. The combined coupling torque of the drive magnet and impeller magnet gives sufficient driving power against the motor torque.

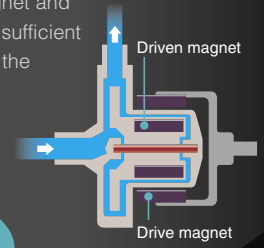

**Operating Principle**

## High corrosion-resistance

GFRPP(Grass fiber reinforced polypropylene) wet ends of the MD series handle a wide range of chemicals.

## Easy maintenance

The pump unit is comprised of a small number of integrated parts, so maintenance is greatly simplified.



MD-40R



MD-55R



MD-70R



MD-100R

### MD-55·70·100 GFRPP 50/60Hz

- Max Discharge capacity **40/43 - 135/135** l/min
- Max Discharge head **5.6/8.2 - 14.3/20.3** m

# Wide variation

## Easy maintenance

The MD series has GFRPP wet ends. Hose connections, threaded connections and flange connections (only 70-100 size) are available. A large selection of models offer a wide flow range of 8.0-135L/min.



### Outline of the series

Main Material	Models	Max. discharge capacity (l/min)							Max. discharge head (m)				Limit of specific gravity	
		20	40	60	80	100	120	140	5	10	15	20		
GFRPP	<b>MD-6</b> Standard type	50Hz	8.0							1.0				1.2
		60Hz	9.0							1.4				
	<b>MD-6Z</b> High head type	50Hz	5.5							2.1				1.1
		60Hz	6.0							2.7				
	<b>MD-10</b> Standard type	50Hz	11							1.5				1.1
		60Hz	12							2.1				
	<b>MD-15R</b> Standard type	50Hz	16							2.4				1.3
		60Hz	19							3.4				
	<b>MD-20R</b> Standard type	50Hz	27							3.1				1.1
		60Hz	31							4.3				
	<b>MD-20RX</b> Large capacity type	50Hz	46							1.8				1.3
		60Hz	52							2.5				
	<b>MD-20RZ</b> High head type	50Hz	10							4.6				1.1
		60Hz	11							6.9				
	<b>MD-30R</b> Standard type	50Hz	32							3.8				1.3
		60Hz	38							5.4				
	<b>MD-30RX</b> Large capacity type	50Hz	62							2.9				1.1
		60Hz	72							4.1				
	<b>MD-30RZ</b> High head type	50Hz	15							8.0				1.0
		60Hz	17							11				
	<b>MD-40R</b> Standard type	50Hz	45							4.6				1.1
		60Hz	52							6.5				
<b>MD-40RX</b> Large capacity type	50Hz	75							3.3				1.1	
	60Hz	85							4.7					
<b>MD-40RZ</b> High head type	50Hz	22							10				1.0	
	60Hz	22							13.5					
<b>MD-40RZ-5</b> 50Hz only	50Hz	11							11.5				1.0	
<b>MD-55R</b> Standard type	50Hz	60							5.6				1.2	
	60Hz	70							8.2					
<b>MD-55R-5</b> 50Hz only	50Hz	70							8.2				1.2	
<b>MD-70R</b> Standard type	50Hz	86							6.7				1.0	
	60Hz	97							9.7					
<b>MD-70RZ</b> High head type	50Hz	40							14.3				1.0	
	60Hz	43							20.3					
<b>MD-100R</b> Standard type	50Hz	120							8.6				1.2	
	60Hz	135							11.9					
<b>MD-100R-5</b> 50Hz only	50Hz	135							11.7				1.1	

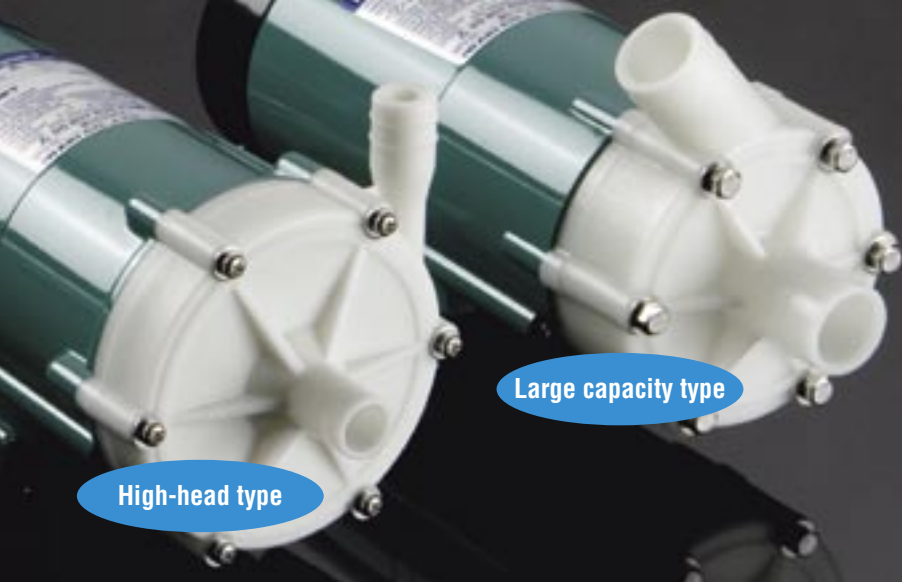

High-head type

Large capacity type

**Construction**

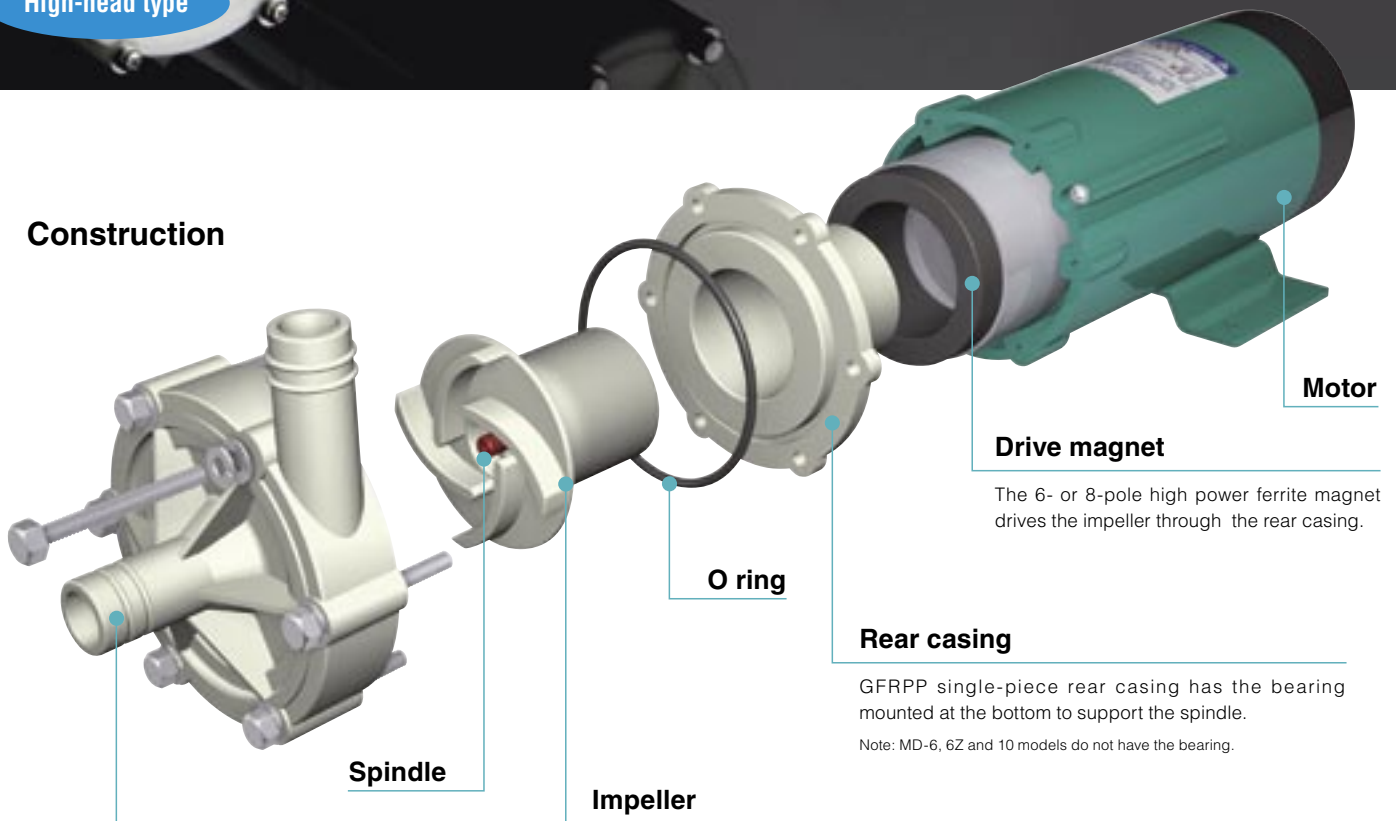

Motor

Drive magnet

The 6- or 8-pole high power ferrite magnet drives the impeller through the rear casing.

O ring

Rear casing

GFRPP single-piece rear casing has the bearing mounted at the bottom to support the spindle.

Note: MD-6, 6Z and 10 models do not have the bearing.

Spindle

Impeller

The ferrite magnet is encapsulated into the impeller. For rotating spindle models, an alumina ceramic spindle is integrally molded with the impeller.

Open, closed or semi-open type impellers can be selected according to performance requirements.

Note: MD-6, 6Z and 10 models use a fixed spindle design.

Front casing

Hose or threaded connections can be selected according to application. Also flanges or union joints can be installed on threaded connection models.

Note: MD-6, 6Z and 10 models do not have thread connection type.



Hose connection type



Thread connection type



Standard type R



High-head type RZ



Large-capacity type RX

# MD-6.10

**GRRPP**  
50/60 Hz

- Range of Max. discharge capacity: **5.5/6.0 - 11/12** L/min
- Range of Max. discharge head: **1.0/1.4 - 2.1/2.7** m



## Specifications (50/60Hz)

Model	Hose connection		Max. Capacity L/min	Max. Head m	S.G.	Output W	Input W	Phase	Mass kg
	Inlet (mm)	Outlet (mm)							
MD-6	14	14	8.0 / 9.0	1.0 / 1.4	1.2	5 / 5	12 / 12	100V Single phase	0.9
MD-6Z			5.5 / 6.0	2.1 / 2.7	1.1		13 / 16		
MD-10			11 / 12	1.5 / 2.1	1.1		13 / 15		

- Temperature range: 0 - 80°C (Contact us for applications below zero.)
- Limit of viscosity: 30 mPa·s (at 1 S.G.)
- Ambient temperature: 0 - 40°C
- Motor type: Capacitor-run induction motor
- MD-6, 6Z and 10 do not have thread connection type.

## Construction and materials

Illustration shows model MD-6

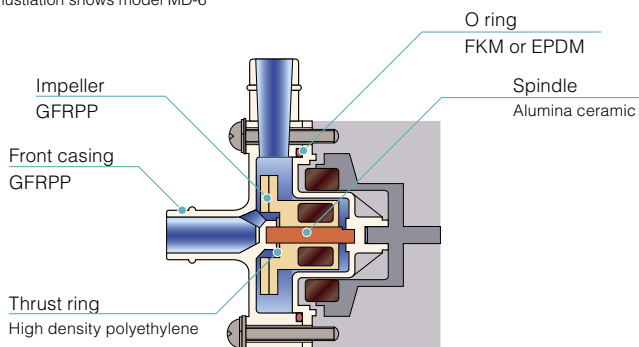

## Pump identification

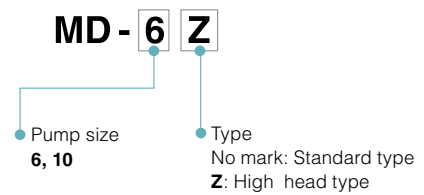

### Performance curves

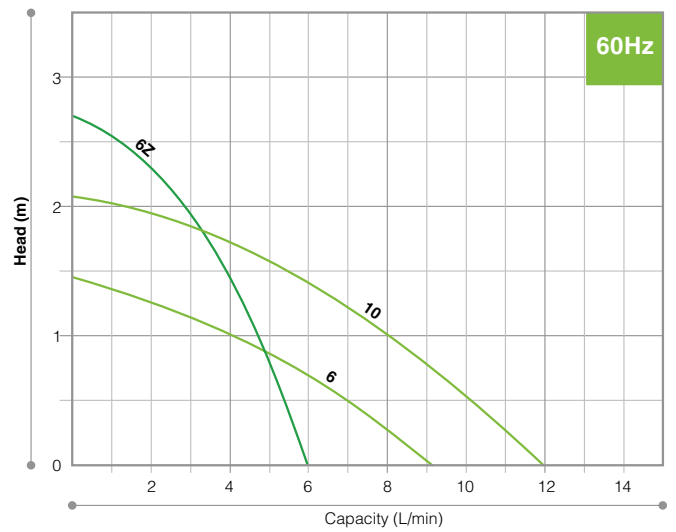
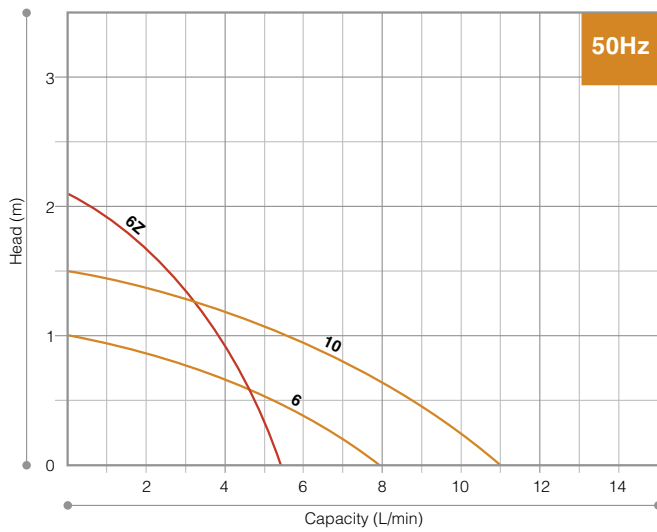

### Dimensions (mm)

**MD-6**

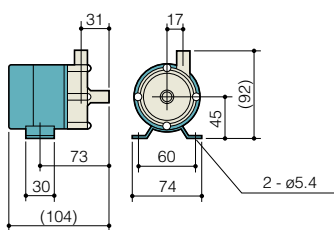

**MD-6Z**

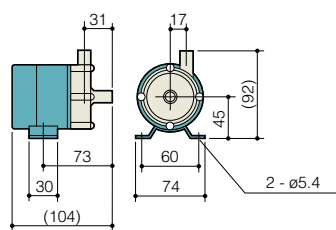

**MD-10**

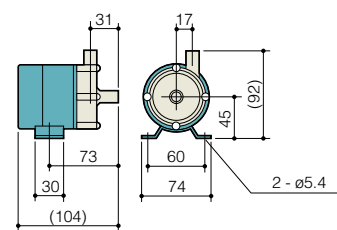

# MD-15·20·30·40

**GRRPP**  
50/60 Hz

- Range of Max. discharge capacity: 10/11 - 75/85 L/min
- Range of Max. discharge head: 1.8/2.5 - 11.5/13.5 m



## Specifications (50/60Hz)

Model	Hose connection		Screwed connection		Max. Capacity (L/min)	Max. Head (m)	S.G.	Output (W)	Input (W)	Power source	Mass (kg)
	R · RZ · RX	R · M · RZ · M · RX · M	Inlet/Outlet	Union (mm) <sup>(Note1)</sup>							
MD-15R	14	14	G3/4	13	16 / 19	2.4 / 3.4	1.3	10 / 10	26 / 31	100V/200V Single phase 220V - 240V Single phase	1.6
MD-20R	18	17	G3/4	16	27 / 31	3.1 / 4.3	1.1	20 / 20	40 / 50		2.0
MD-20RX	26	26	G1	20	46 / 52	1.8 / 2.5	1.3				
MD-20RZ	17.5	17	G3/4	13	10 / 11	4.9 / 6.9	1.1				
MD-30R	20	20	G3/4	16	32 / 38	3.8 / 5.4	1.3	45 / 45	60 / 80	3.5	
MD-30RX	26	26	G1	20	62 / 72	2.9 / 4.1	1.1		70 / 90		
MD-30RZ	17.5	17	G3/4	13	15 / 17	8.0 / 11	1.0				
MD-40R	20	20	G3/4	16	45 / 52	4.6 / 6.5	1.1	65 / 65	90 / 130	3.9	
MD-40RX	26	26	G1	20	75 / 85	3.3 / 4.7			85 / 120		
MD-40RZ	20	20	G3/4	16	22 / 22	10 / 13.5	1.0	140 / 200			
MD-40RZ-5					11 / -	11.5 / -		65 / -	140 / -		

- Temperature range: 0 - 80°C (Contact us for applications below zero.) • Limit of viscosity: 30 mPa·s (at 1 S.G.) • Ambient temperature: 0 - 40°C
- Motor type: Capacitor-run induction motor

Note 1: The union field shows the nominal diameter of the applicable VP vinyl chloride hose. Heat resistance of the standard union is 0 - 55°C and that of the heat resistant union is 0 - 80°C.  
Note 2: Single phase of 200V model is special order. Please contact us for details.

## Construction and materials

Illustration shows model MD-30R-N

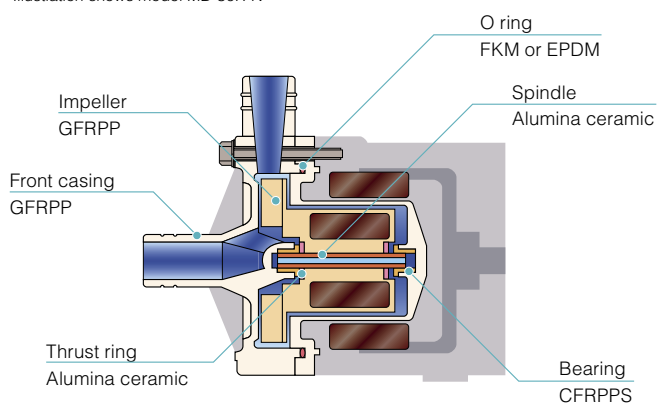

### MD - 30 RZ - 5 M - 200 E N

- Pump size  
**15, 20, 30, 40**
- Type  
**R**: Standard type  
**RZ**: High head type  
**RX**: High capacity type
- Frequency  
No mark: common 50/60Hz  
**- 5**: 50Hz only (for 40RZ)
- Material of O ring  
No mark: FKM (Standard)  
**E**: EPDM (Special order)
- Motor  
No mark: 100V single phase  
**200**: 200V single phase  
**220**: 220V - 240V single phase
- Connection  
No mark: Hose type  
**M**: G thread connection



30

MD-30R



40

MD-40R

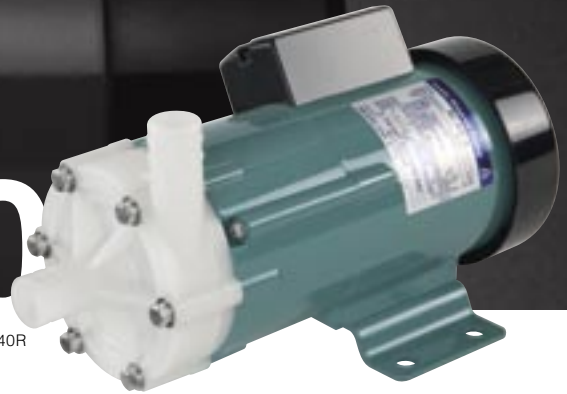

**Performance curves**

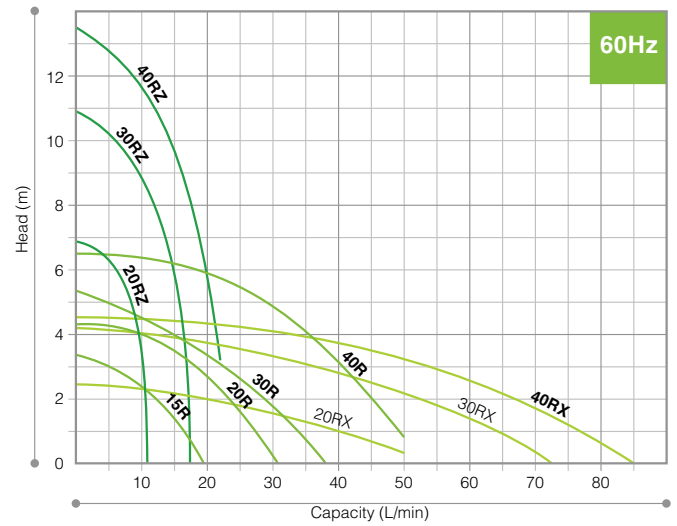
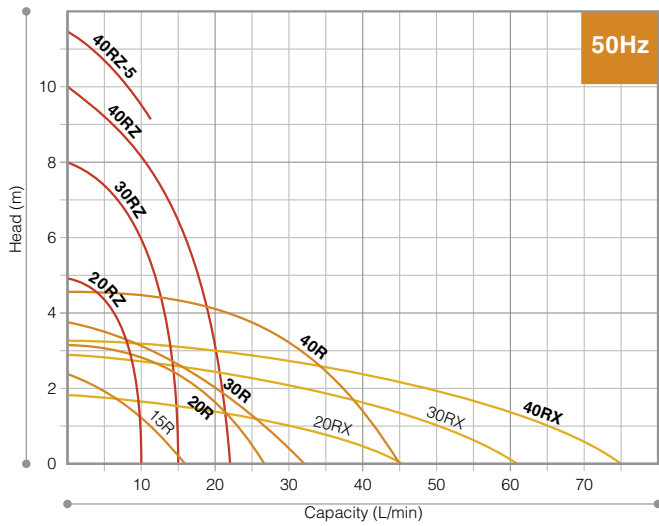

**Dimensions (mm)**

**MD-15R-20R-30R-40R**

Illustration shows MD-30R-N

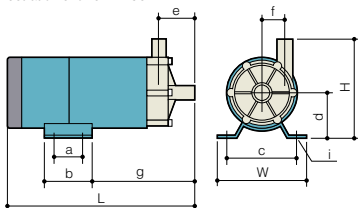

Model	W	H	L	a	b	c	d	e	f	g	i
MD-15R	95	109 (114)	180 (179)	-	50	68	55	39	22	92	2 - $\phi$ 5.6
MD-20R	106	105 (107)	209 (203)	44	60	90	45	39 (33)	29	94 (88)	4 - 6x10
MD-30R	120	130	248	40	64	100	60	48	31	137	4 - $\phi$ 9
MD-40R			250								

Note1: Dimension of the ( ) inside are thread connection type.

**MD-20RZ-30RZ-40RZ**

Illustration shows MD-20RZ-N

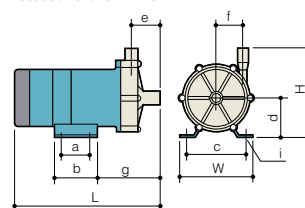

Model	W	H	L	a	b	c	d	e	f	g	i
MD-20RZ	106	125	211	44	60	90	55	40	39	98	4 - 6x10
MD-30RZ			230							120	
MD-40RZ			241	40	64	100	60	39	45	128	4 - $\phi$ 9
MD-40RZ-5											
MD-20RX	106	119 (122)	220	44	60	90	45	47	-	105	4 - 6x10
MD-30RX			254							143	
MD-40RX	120	137 (141)	256	40	64	100	60	50	-	143	4 - $\phi$ 9

Note1: Dimension of the ( ) inside are thread connection type.

Note2: RZ type (Hose connection) and RZM type (Thread connection type) are the same dimensions.

# MD-55.70.100

**GRRPP**  
50/60 Hz

- Range of Max. discharge capacity: **40/43 - 135/135** L/min
- Range of Max. discharge head: **5.6/8.2 - 14.3/20.3** m



# 55

# 7

MD-55R

## Specifications (50/60Hz)

Model	Hose connection		Screwed connection		Diameter of flange	Max. Capacity (L/min)	Max. Head (m)	S.G.	Output (W)	Input (W)	Power source <sup>(Note2)</sup>		Mass (kg)
	R · RZ		R-M · RZ-M								Single phase	Three phase	
	Inlet (mm)	Outlet (mm)	Inlet/Outlet	Union <sup>(Note1)</sup> (mm)									
<b>MD-55R</b>	26	26	G1	20	-	60 / 70	5.6 / 8.2	1.2	90 / 90	130 / 170	100V/200V/ 220V - 240V	-	5.4
<b>MD-55R-5</b>					-	70 / -	8.2 / -		90 / -	170 / -			
<b>MD-70R</b>	26	26	G1	20	20A	86 / 97	6.7 / 9.7	1.0	150 / 180	235 / 365	220V/380V/ 400V/440V	6.0	
<b>MD-70RZ</b>	20	20	G3/4	16	-	40 / 43	14.3 / 20.3		180 / 216	275 / 395			
<b>MD-100R</b>	26	26	G1	20	25A	120 / 135	8.6 / 11.9	1.2	260 / 265	245 / 365			8.5
<b>MD-100R-5</b>						135 / -	11.7 / -	1.1	260 / -	365 / -			

- Temperature range: 0 - 80°C (Contact us for applications below zero.) • Limit of viscosity: 30 mPa·s (at 1 S.G.) • Ambient temperature: 0 - 40°C
- Motor type: Capacitor-run induction motor

Note 1: The union field shows the nominal diameter of the applicable VP vinyl chloride hose. Heat resistance of the standard union is 0 - 55°C and that of the heat resistant union is 0 - 80°C.  
 Note 2: Single phase of 200V model is special order. Please contact us for details.

## Construction and materials

Illustration shows model MD-100R

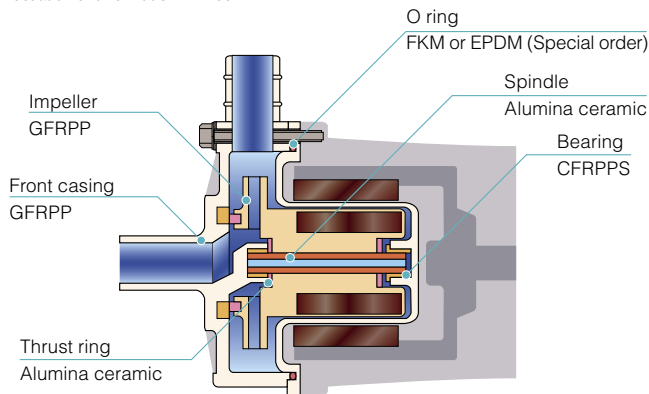

## Pump identification

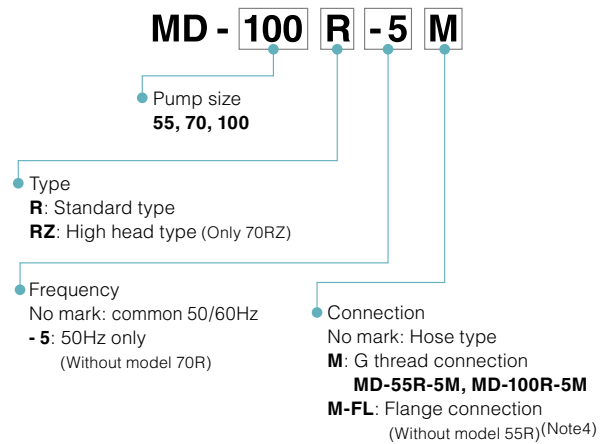

Note3: Specify the pump model and power specification at an inquiry phase.  
 Note4: For the MD-100 of 50Hz flange connection type, the model code is different from others. **MD-100RM-5-FL**

0 100

MD-70R

MD-100R

**Performance curves**

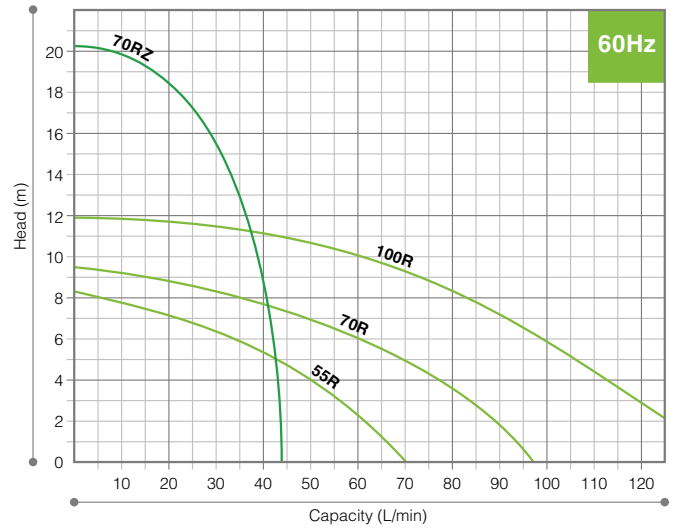
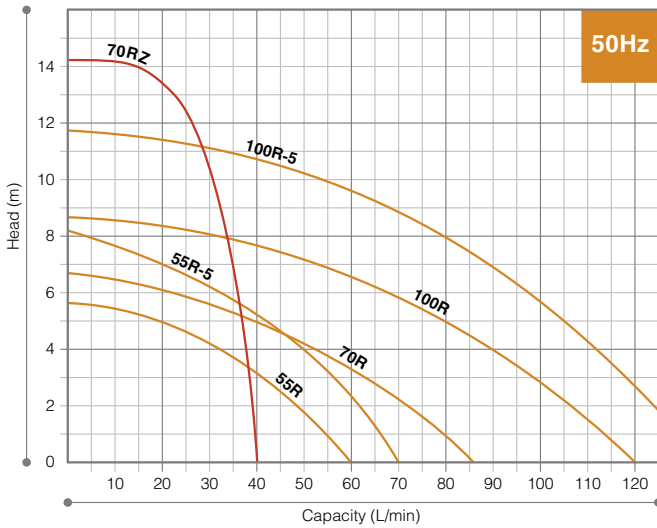

**Dimensions (mm)**

**MD-55R-55R-5**  
Illustration shows MD-55R

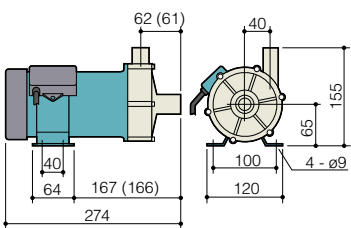

**MD-70R**

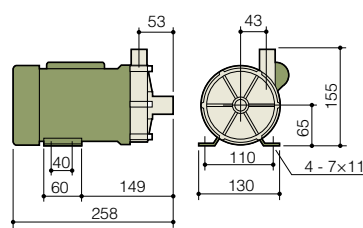

**MD-70RZ**

( ) : Thread connection type

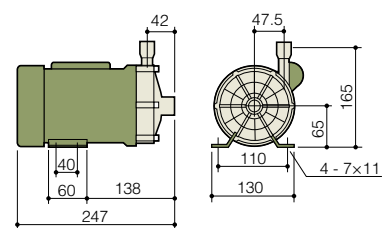

**MD-70RM-FL**

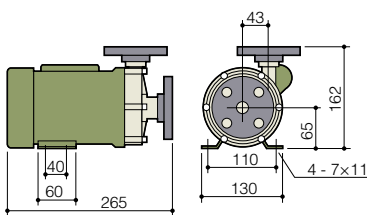

**MD-100R-100R-5**

Illustration shows MD-100R

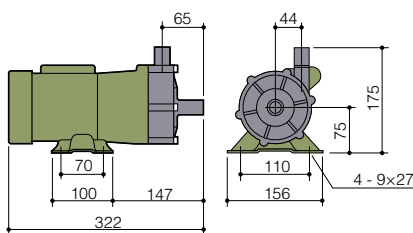

**MD-100RM-FL-100RM-5-FL**

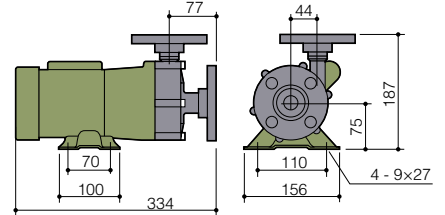

## Special accessories

### • Union joint

Special-purpose union joints are available to cope with three types (13mm, 16mm and 20mm dia.) of piping. Tight sealing O-rings are used to prevent thread damage caused by over tightening.



### • Self-priming chamber

Once fill up liquid, repriming is not required. It is very easy to use MD pump with self-priming chamber.



### Specifications

Model	13A	H13A	16A	H16A	20A	H20A
Material	PVC	HT-PVC	PVC	HT-PVC	PVC	HT-PVC
Range of temp.	0 - 55°C	0 - 80°C	0 - 55°C	0 - 80°C	0 - 55°C	0 - 80°C
Material of O ring	FKM or EPDM					

### Specifications

Model	SC-4V	SC-4E	SC-7V	SC-7E
Material of O ring	FKM	EPDM	FKM	EPDM
Connection	G3/4		G1	
Suction limit	0.8 m		1.2 m	
Range of tank	0.8 L		1.3 L	
Applicable pump	MD-30RM-N, MD-40RM-N		MD-70RM	

Note: Self-priming height depends on liquid temperature and characteristics.

## Compact & Lightweight

The canned motor pump offers a solution for built-in application

### Direct drive pumps **RD** series

- Lightweight & sealless structure
- Plastic canned motor pump
- DC 24 V brushless motor
- Employ built-in type driver for the motor
- The variable flow and pressure control by DC 1 to 5 V signal
- Corresponds to high temperature range Max. 80°C
- The connection of three types can be chosen, thread, hose and quick fastener.



### Specification

RD-05, RD-05H, RD-20, RD-30

Model	Connection (IN x OUT) mm	Max. capacity L/min	Max. head m	Motor					Weight kg
				Output W	Power consumption W	Revolution speed min <sup>-1</sup>	Power voltage VDC	Rated	
RD-05	14 x 8	4	3	4	10	3500	24	continuous	0.4
RD-05H		6	9	18	39	6000		Intermittent	
RD-20	18 x 18	15	8	28	60	3200	24	continuous	1.3
RD-30		20	10	45	77	3500		continuous	

RD-12, RD-12Z (Power source 24 VDC Input signal 5.0 VDC)

Model	Connection (IN x OUT)			Max. capacity L/min	Max. head m	Power consumption W	Rated voltage VDC	Operating condition	Ambient temperature °C	Liquid temperature range °C	Mass kg
	Quick fastener	Thread	Hose mm								
RD-12	P16 x P14	NPT3/8 x NPT3/8	18 x 18	10	6	24	24	continuous	0 - 50	0 - 75	0.4
RD-12Z	P16 x P10	NPT3/8 x NPT1/4	18 x 10	3	9	28.8	24	continuous	0 - 50	0 - 60	

Please contact us for details.

www.iwakipumps.jp

IWAKI CO.,LTD. 6-6 Kanda-Sudacho 2-chome Chiyoda-ku Tokyo 101-8558 Japan TEL : (81)3 3254 2935 FAX : 3 3252 8892

### EUROPE / U.S.A.

European office : IWAKI Europe GmbH TEL: (49)2154 9254 0 FAX: 2154 9254 48  
 Austria : IWAKI (Austria) GmbH TEL: (41)26 674 93 00 FAX: 26 674 93 02  
 Belgium : IWAKI Belgium N.V. TEL: (32)13 67 02 00 FAX: 13 67 20 30  
 Denmark : IWAKI Nordic A/S TEL: (45)48 24 2345 FAX: 48 24 2346  
 Finland : IWAKI Suomi Oy TEL: (358)9 2745810 FAX: 9 2742715  
 France : IWAKI France S.A. TEL: (33)1 69 63 33 70 FAX: 1 64 49 92 73  
 Germany : IWAKI Europe GmbH TEL: (49)2154 9254 50 FAX: 2154 9254 55  
 Holland : IWAKI Holland B.V. TEL: (31)297 241121 FAX: 297 273902  
 Italy : IWAKI Italia S.R.L. TEL: (39)02 990 3931 FAX: 02 990 42888  
 Norway : IWAKI Norge AS TEL: (47)66 81 16 60 FAX: 66 81 16 61  
 Spain : IWAKI Iberica Pumps, S.A. TEL: (34)943 630030 FAX: 943 628799  
 Sweden : IWAKI Sverige AB TEL: (46)8 511 72900 FAX: 8 511 72922  
 Switzerland : IWAKI (Schweiz) AG TEL: (41)26 674 93 00 FAX: 26 674 93 02  
 U.K. : IWAKI Pumps (UK) Ltd. TEL: (44)1743 231363 FAX: 1743 366507  
 U.S.A. : IWAKI America Inc. TEL: (1)508 429 1440 FAX: 508 429 1386

### ASIA / OCEANIA

Australia : IWAKI Pumps Australia Pty Ltd. TEL: (61)2 9899 2411 FAX : 2 9899 2421  
 China : TEL: (852)2607 1168 FAX: 2607 1000  
 Hong Kong : IWAKI Pumps Co., Ltd. TEL: (86)21 6272 7502 FAX: 21 6272 6929  
 Shanghai : IWAKI Pumps (Shanghai) Co., Ltd. TEL: (86)20 8435 0603 FAX: 20 8435 9181  
 Guangzhou : GFTZ IWAKI Engineering & Trading Co., Ltd. TEL: (86)10 6442 7713 FAX: 10 6442 7712  
 Beijing : GFTZ Iwaki Engineering & Trading Co., Ltd. (Beijing office) TEL: (82)2 2630 4800 FAX: 2 2630 4801  
 Korea : IWAKI Korea Co., Ltd. TEL: (60)3 7803 8807 FAX: 3 7803 4800  
 Malaysia : IWAKIm Sdn. Bhd. TEL: (65)6316 2028 FAX: 6316 3221  
 Singapore : IWAKI Singapore Pte Ltd. TEL: (62)21 6906606 FAX: 21 6906612  
 Indonesia : IWAKI Singapore (Indonesia Branch) TEL: (886)2 8227 6900 FAX: 2 8227 6818  
 Taiwan : IWAKI Pumps Taiwan Co., Ltd. TEL: (66)2 322 2471 FAX: 2 322 2477  
 Thailand : IWAKI (Thailand) Co., Ltd. TEL: (84)613 933456 FAX: 613 933399  
 Vietnam : IWAKI Pumps Vietnam Joint Venture Co., Ltd. TEL: (84)613 933456 FAX: 613 933399

( )Country codes

⚠ Caution for safety use: Before use of pump, read instruction manual carefully to use the product correctly.

Actual pumps may differ from the photos. Specifications and dimensions are subject to change without prior notice. For further details please contact us.